

REFER TO HYDROTECHS GUIDELINE ROOFING & WATERPROOFING DETAILS FOR SUGGESTED TERMINATIONS, FLASHING AND MEMBRANE DETAILING SPECIFICS

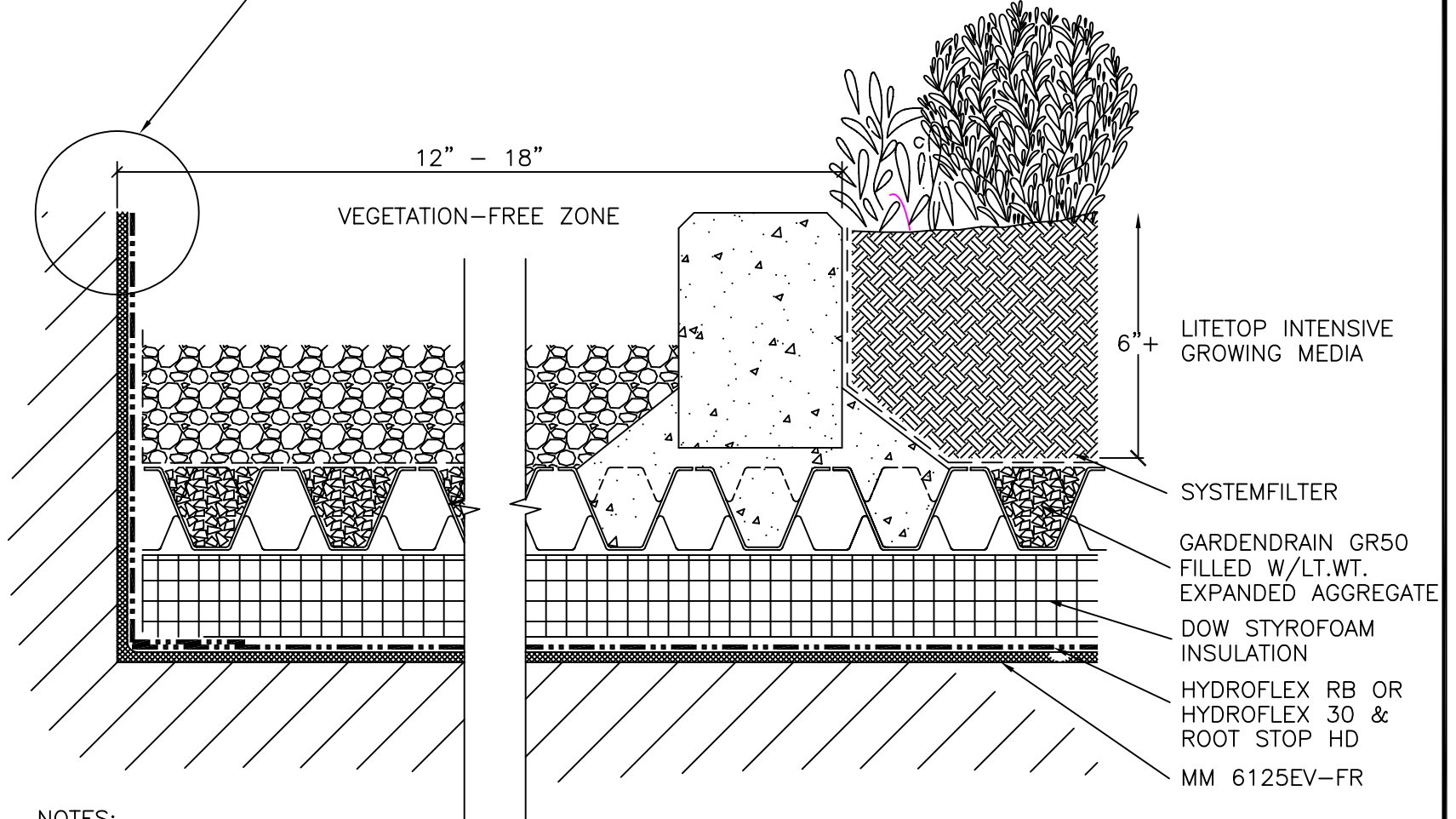

NOTES:

TO ACCOMMODATE DEEPER INTENSIVE SOIL DEPTHS, INSTALLATION OF A "SOIL STOP" WILL TYPICALLY BE REQUIRED. THE SOIL STOP CAN BE PRECAST OR POURED-IN-PLACE CONCRETE CURBS, LANDSCAPING TIMBERS, ETC. IF SECUREMENT OF THE SOIL STOP IS NECESSARY, A CONCRETE FOOTING CAN BE POURED USING THE GR50 AS THE FORM.

THE VEGETATION-FREE ZONE MAY BE COMPOSED OF TYPICAL STONE BALLAST OR CONCRETE PAVERS. V-F ZONES ARE REQUIRED AT ALL ROOF PERIMETERS AND ALL PENETRATIONS (PIPES, SKYLIGHTS, ETC.)

TYP. INTENSIVE GARDEN ROOF
TERM. DETAIL (i.e., WALL, CURB, PIPE)

NO SCALE

GR-3